



Vasche e lavelli sottopiano raggio 12 *Undermount bowls and sinks radius 12*



Le vasche e i lavelli raggio 12 nella versione da sottopiano si installano sotto il top della cucina. Spaziano da misure minime a misure professionali, sono molto alte, con pareti verticali e angoli a raggio minimo per ottenere la massima capienza. La varietà di modelli proposta e il sistema di accessori dedicato moltiplicano esponenzialmente le possibilità combinatorie. L'area lavaggio diventa uno spazio flessibile e organizzato che si adatta in modo sartoriale ad esigenze e abitudini diverse.

Undermount bowls and sinks radius 12 are installed under the kitchen countertop. They range from minimal to professional sizes, they're very high, with vertical walls and corners with minimal radius which make them more capacious. The variety of models and the range of dedicated accessories increase exponentially the possible solutions. The washing area becomes a flexible and organised working space which can be adapted to meet perfectly all kinds of daily needs.

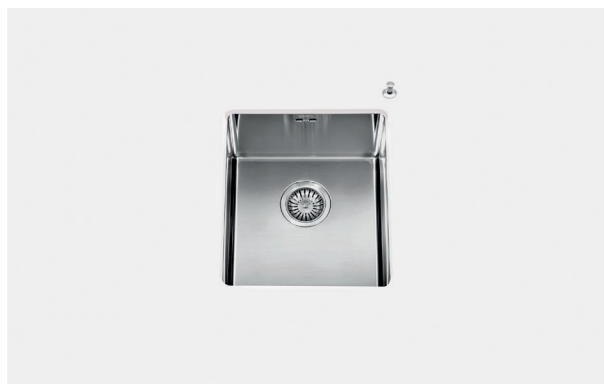

VSR 34
BASE 45

820 €

Vasca sottopiano - 40x34 cm
Undermount bowl - 40x34 cm

Dimensioni
Measurements

Dimensione totale *Total measurements* 43x37 cm H 29,7 cm
Dimensione utile *Working size* 40x34 cm H 20 cm
Dimensione foro incasso *Cutout size* 40x34 cm - R 1,25
Dimensione foro incasso pomello *Cutout size for control knob* Ø 2,5 cm

Accessori
Accessories

BF 10 Bacinella inox con fondo forato *Stainless steel basin with perforated bottom*



VSR 40
BASE 60

840 €

Vasca sottopiano - 40x40 cm
Undermount bowl - 40x40 cm

Dimensione totale *Total measurements* 43x43 cm H 29,7 cm
Dimensione utile *Working size* 40x40 cm H 20 cm
Dimensione foro incasso *Cutout size* 40x40 cm - R 1,25
Dimensione foro incasso pomello *Cutout size for control knob* Ø 2,5 cm

TP/R12-VL Tagliere in polietilene *Polyethylene chopping board*
TL/R12-VL Tagliere in teak *Teak chopping board*
BF 10 Bacinella inox con fondo forato *Stainless steel basin with perforated bottom*

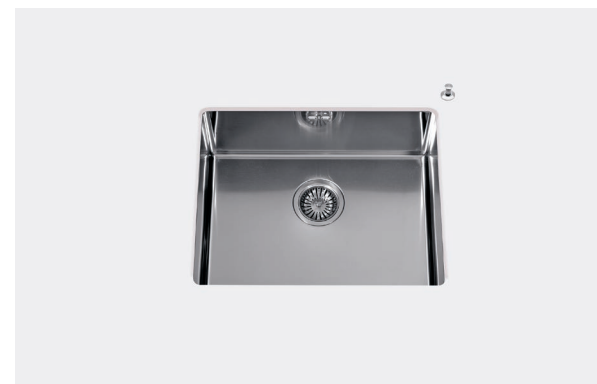

VSR 50
BASE 60

860 €

Vasca sottopiano - 40x50 cm
Undermount bowl - 40x50 cm

Dimensione totale *Total measurements* 43x53 cm H 29,7 cm
Dimensione utile *Working size* 40x50 cm H 20 cm
Dimensione foro incasso *Cutout size* 40x50 cm - R 1,25
Dimensione foro incasso pomello *Cutout size for control knob* Ø 2,5 cm

TP/R12-VL Tagliere in polietilene *Polyethylene chopping board*
TL/R12-VL Tagliere in teak *Teak chopping board*
BF 10 Bacinella inox con fondo forato *Stainless steel basin with perforated bottom*

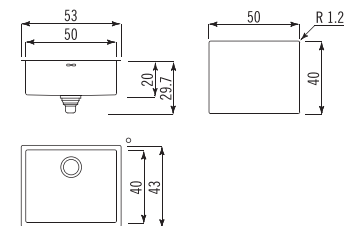
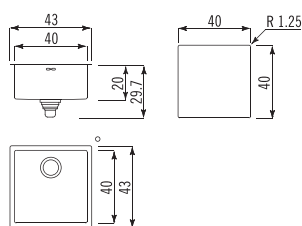
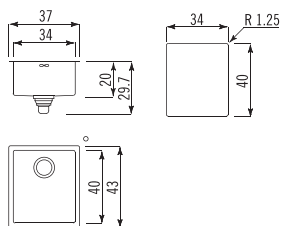



**VSR 70
BASE 80**

970 €

Vasca sottopiano - 40x70 cm
Undermount bowl - 40x70 cm

Dimensione totale *Total measurements* 43x73 cm H 29,7 cm
Dimensione utile *Working size* 40x70 cm H 20 cm
Dimensione foro incasso *Cutout size* 40x70 cm – R 1,25
Dimensione foro incasso pomello *Cutout size for control knob* Ø 2,5 cm

TP/R12-VL Tagliere in polietilene *Polyethylene chopping board*
TL/R12-VL Tagliere in teak *Teak chopping board*
BF 10 Bacinella inox con fondo forato *Stainless steel basin with perforated bottom*

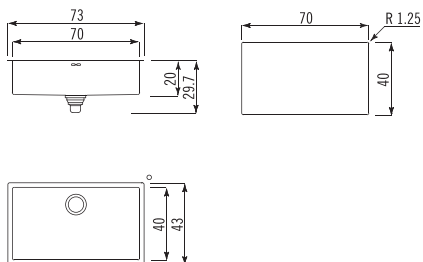

**VSR 80
BASE 90**

1.010 €

Vasca sottopiano - 40x80 cm
Undermount bowl - 40x80 cm

Dimensione totale *Total measurements* 43x83 cm H 29,7 cm
Dimensione utile *Working size* 40x80 cm H 20 cm
Dimensione foro incasso *Cutout size* 40x80 cm – R 1,25
Dimensione foro incasso pomello *Cutout size for control knob* Ø 2,5 cm

TP/R12-VL Tagliere in polietilene *Polyethylene chopping board*
TL/R12-VL Tagliere in teak *Teak chopping board*
BF 10 Bacinella inox con fondo forato *Stainless steel basin with perforated bottom*

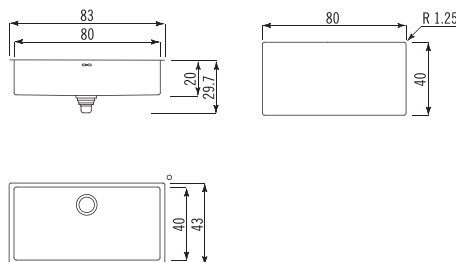

**LSR 83/2V
BASE 90**

1.530 €

Lavello sottopiano 43x83,5 cm con due vasche uguali raggio 12
Undermount sink 43x83,5 cm with two bowls radius 12 of the same size

Dimensione lavello *Sink size* 43x83,5 cm H 29,7 cm
Dimensioni vasche *Bowls size* 40x39 cm, 40x39 cm H 20 cm
Dimensione foro incasso *Cutout size* 40x80,5 cm – R 1,25
Dimensione foro incasso pomello *Cutout size for control knob* Ø 2,5 cm

TP/R12-VL Tagliere in polietilene *Polyethylene chopping board*
TL/R12-VL Tagliere in teak *Teak chopping board*
BF 10 Bacinella inox con fondo forato *Stainless steel basin with perforated bottom*

